

Land off Oakhurst Rise,
Charlton Kings,
Cheltenham

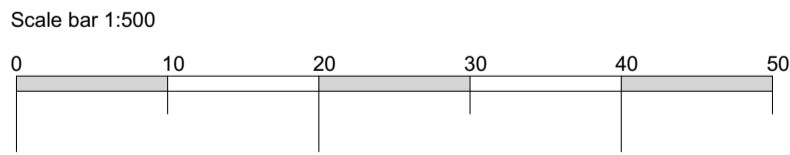
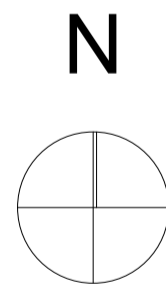
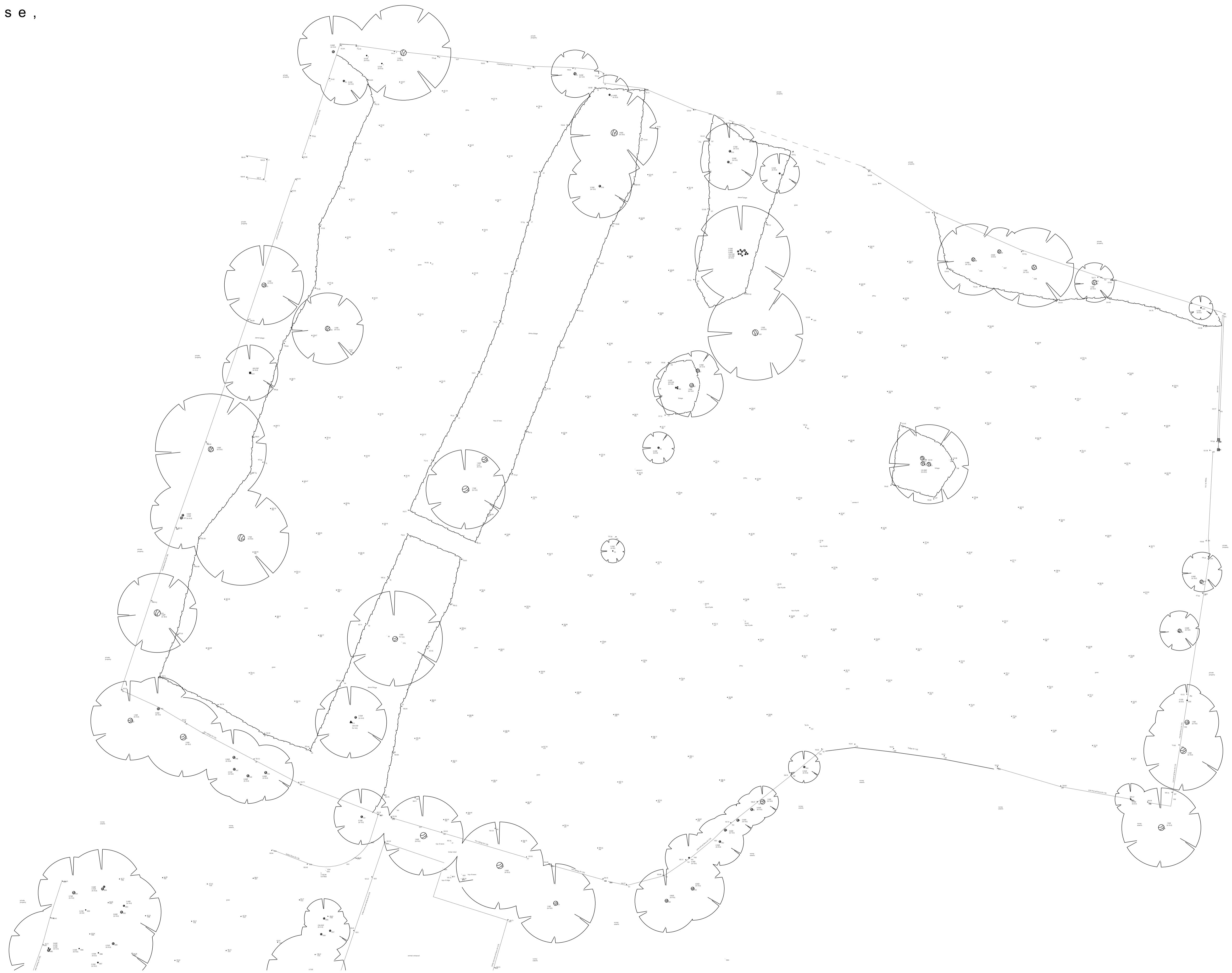

coombes : everitt architects limited

Unit No.1, The Old Dairy
Rushley Lane
Winchcombe
Gloucestershire
GL54 5JE

t: 01242 807727 f: 0845 5575833
e: info@ce-architects.co.uk
www.ce-architects.co.uk

- Preliminary
- Feasibility
- Planning
- Building Regulations
- Tender
- Construction issue
- As Built

1. This drawing and content is copyright © of coombes : everitt architects limited and should not be copied without their prior written consent.
2. Do not scale drawing. all dimensions to be checked on site prior to construction and any discrepancies reported to contract administrator.
3. Do not use this drawing for setting out unless drawing specifically indicates setting out points.
4. Engineering information is indicative only and should be taken from structural engineers design.



Drawing title: Topographical Site Survey

Client: William Morrison (Cheltenham) Ltd & The Trustees of the Carmelite Charitable Trust

Drawn by: AH Checked: JE

Project No: 16.20.034

Project: Land off Oakhurst Rise,
Charlton Kings,
Cheltenham

Scale: 1:500 @ A1

Date: April 2020

Project / Drawing No: PL002